

Settings

Model		126
Setting "a" for over-center spring, measured across both spring seats		43.5
Pedal travel "c"	Brake pedal	140

1) To point of contact at pedal stop.

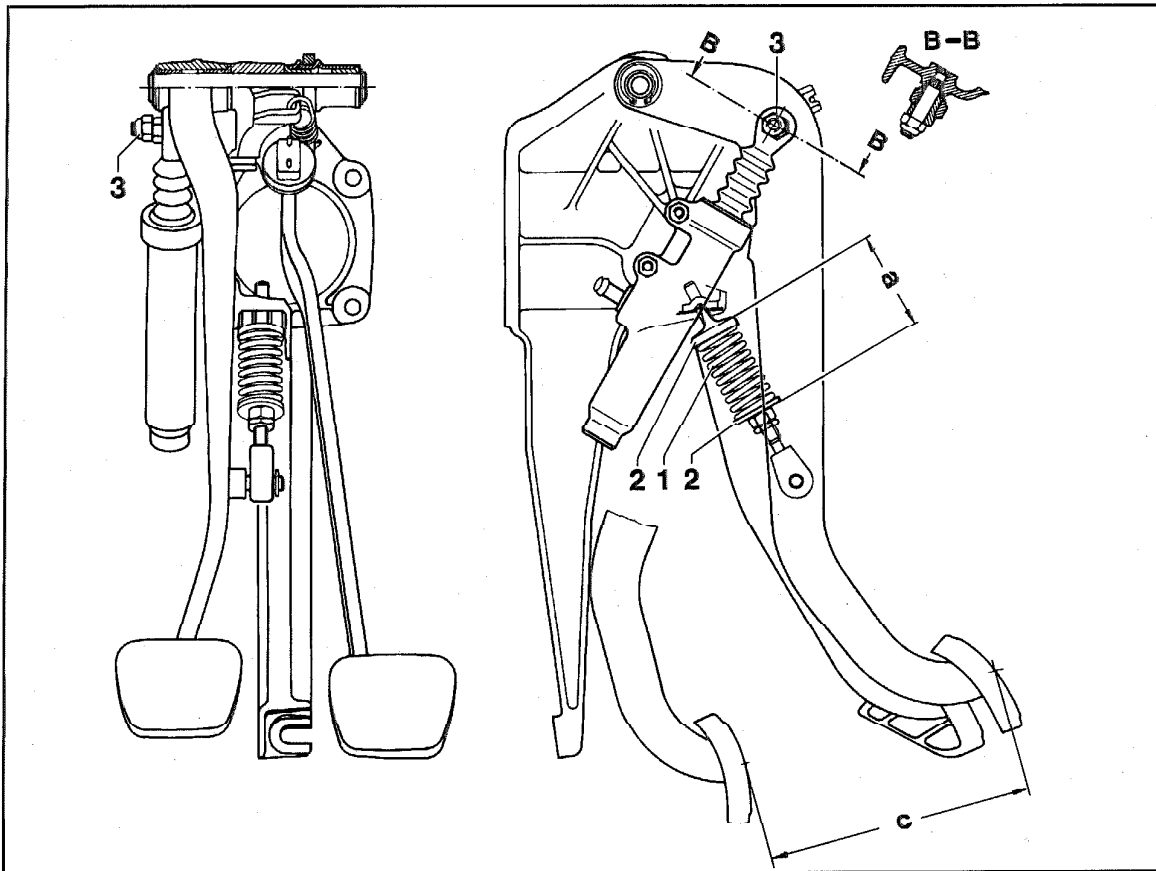

P29-5051-57

- 1 Over-center spring
- 2 Spring seats
- 3 Adjusting screw

- a Setting for over-center spring
- c Pedal travel

29-320 R and R pedals

Removing and installing

- 1 Remove panelling under left side of instrument panel.
- 2 Remove left foot mat.
- 3 To avoid contaminating the interior of the vehicle, siphon off the brake fluid from the appropriate chamber of the combined brake and clutch fluid reservoir.

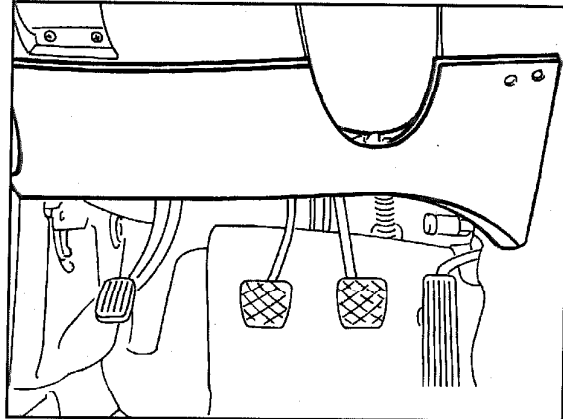

P29-5052-13

- 4 Unscrew line at master cylinder.

Installation note

Bleed clutch mechanism (29-072).
Check function of clutch and test for leaks.

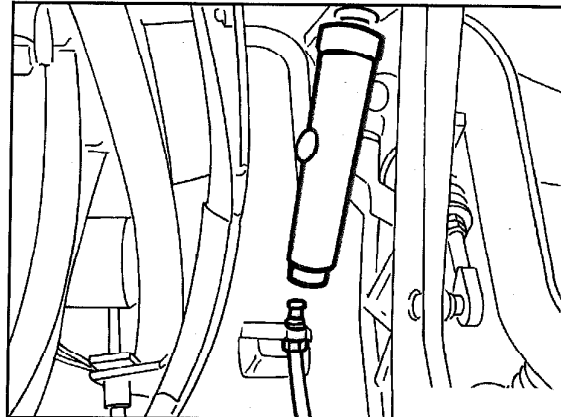

P29-5053-13

5 Pull off connecting hose on combined brake and clutch fluid reservoir and pull through the rubber grommet.

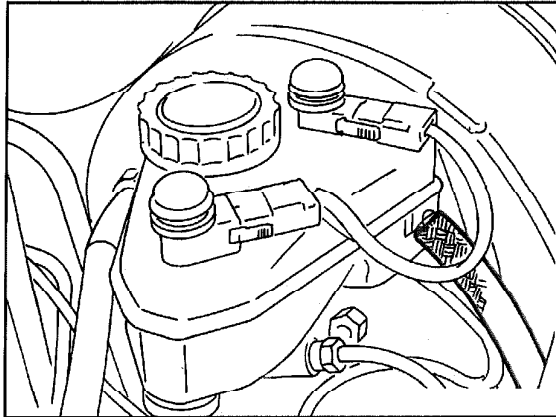

P29-5032-13

6 Remove clip from shouldered pin and remove shouldered pin from brake pedal.

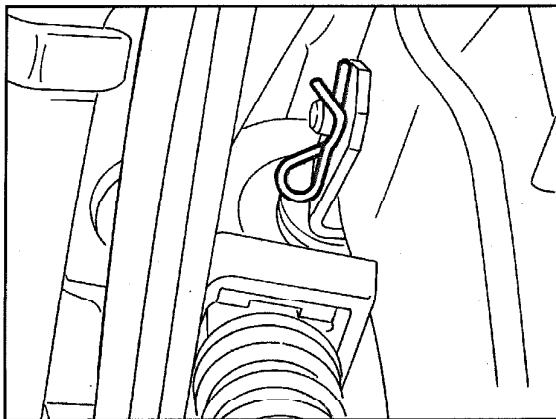

P29-5054-13

7 Disconnect cable plug from stop lamp switch.

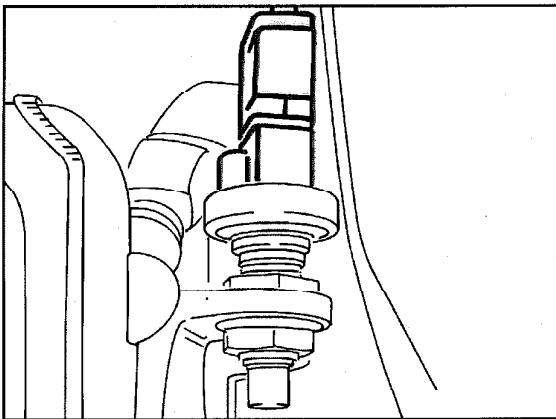

P29-5055-13

29-320 R and R pedals

8 Unscrew nuts holding pedals to firewall (arrow).

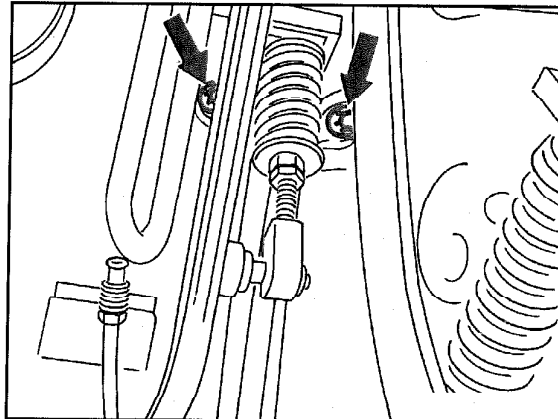

P29-5056-13

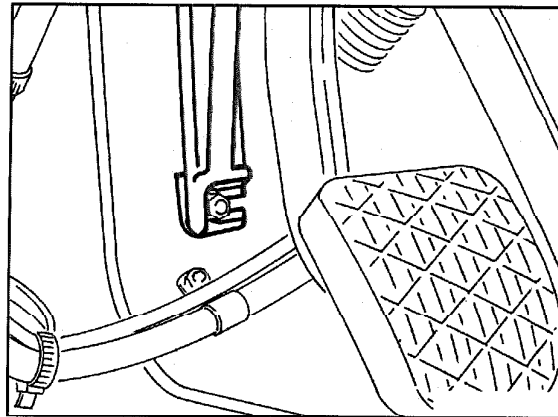

P29-5057-13

9 Move pedals backwards until the screw plate of the pedal carrier disengages from the screw pins. Take care not to disturb the heater hose running behind the instrument panel.

10 Remove pedals downwards, taking care not to disturb the connecting hose to the master cylinder.

11 Install in the reverse sequence.